

## CMU BLOCK WALL – BELOW GRADE – EXTERIOR APPLICATION

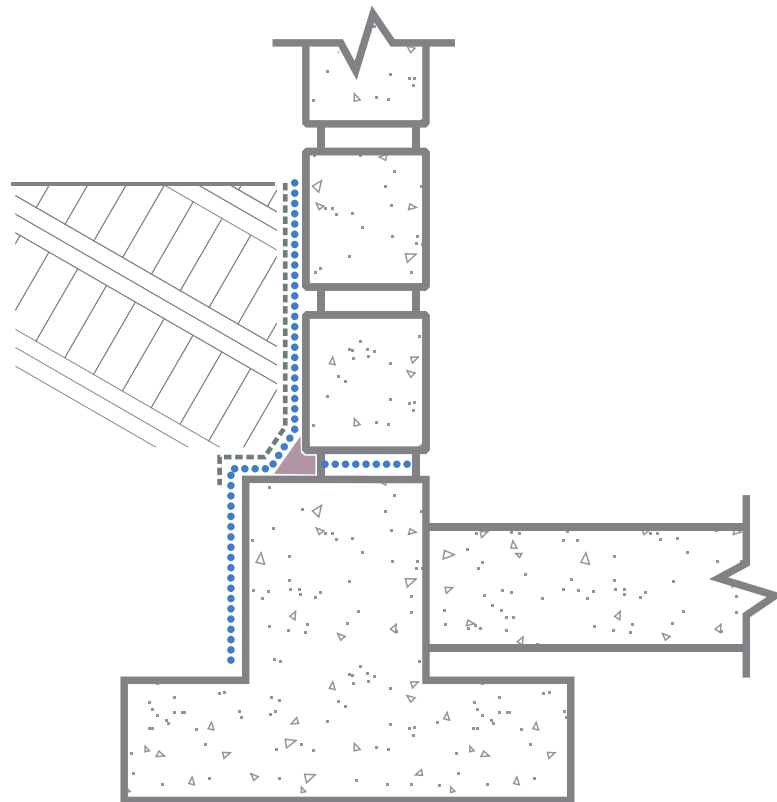

..... CONCENTRATE SLURRY COAT    
 ---- MEGAMIX I    
 ■ NON-POLYMER MORTAR

**STEP 1:** Clean joint thoroughly. Apply Xypex Concentrate slurry to joint surface at the rate of 2.0 lb./sq.yd. (1.0 kg/m<sup>2</sup>).

**STEP 2:** At the base of the wall on the exterior install a triangulare cove of good quality, non-polymer modified mortar.

**STEP 3:** Thoroughly profile, clean and saturate the outside surface of all CMU block walls as well as any concrete surfaces that will receive Xypex coatings. Surfaces to have a “tooth and suction” ICRI CSP-3 profile and be fully saturated with no glistening water on the surface.

**STEP 4:** As shown, install a fillet of good quality non-polymer modified mortar at CMU to concrete interface.

**STEP 5:** Apply one coat of Xypex Concentrate at the rate of 2.0 lb./sq.yd. (1.0 kg/m<sup>2</sup>) to all CMU block and concrete. Allow Xypex Concentrate coating to set and harden for between 12 hours and 24 hours (no more than 48 hours). During this time, moist cure coating per Xypex product data sheet.

**STEP 6:** Apply one coat of Megamix I over top of Xypex Concentrate coated CMU only. Apply Megamix I at a thickness of 1/8” (3 mm) or 11.25 lb./sq.yd. (5.6 kg/m<sup>2</sup>). Thickness of top coating may be varied from 1/16” - 3/8”

(1.5 - 10 mm) depending on job conditions and requirements. Dampen Xypex Concentrate surface ahead of application of Megamix I as required to maintain a damp but not glistening substrate (saturated surface dry condition).

**STEP 7:** In most situations, no moist curing of Xypex Megamix I is required but in rapid drying conditions, Megamix I should be allowed to fully set and then be misted periodically to keep moist for 24 hours. Backfill and place into service per Xypex coatings guidelines

**Note 1:** Schematic diagram shows Xypex application details only and does not depict standard requirements for waterstops or expansion joints. Inclusion, type and position of waterstops are at the discretion of the designer. Expanding waterstops may be placed on the slurry coat after it has dried or before application. Slurry coat may only be applied over waterstop if approved by waterstop manufacturer.

**Note 2:** Schematic drawing shows Xypex coating application. Specifier may consider the alternative use of Xypex dry shake (DS-Series) or Xypex additive (Admix C-Series). Refer to Xypex Standard Specifications for more information.