

WALL WITH KICKER

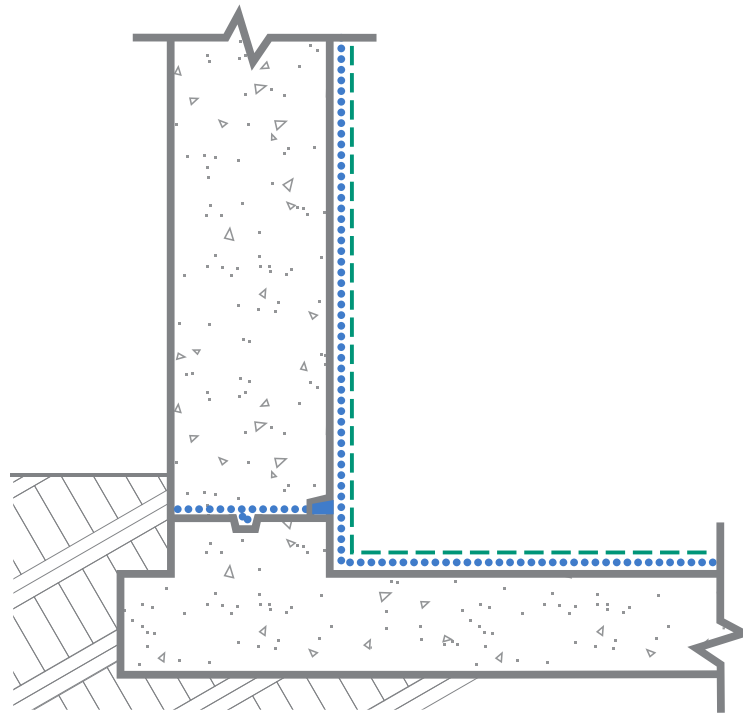

..... CONCENTRATE SLURRY COAT
 ■ CONCENTRATE DRY-PAC
 - - - MODIFIED SLURRY COAT

STEP 1: Clean joint thoroughly. Apply Xypex Concentrate slurry to joint surface at the rate of 2.0 lb./sq.yd. (1.0 kg/m²).

STEP 2: On the inside of the tank, modify the forms to create a linear groove in the finished concrete surface. The linear groove is to be aligned with and included at all construction joints and to be 1" (25 mm) high by 1½" (37 mm) deep.

STEP 3: Pour concrete and cure in accordance with ACI, EN or other applicable international standard. Strip forms including formwork for linear groove.

STEP 4: Clean linear groove thoroughly. Apply Xypex Concentrate slurry to the linear groove at the rate of 1.5 lb./sq.yd. (0.8 kg/m²). Fill linear groove with Xypex Concentrate Dry-Pac and pack tightly to create the Xypex "sealing strip".

STEP 5: Thoroughly profile, clean and saturate the inside surface of all walls, floor and other concrete that will receive Xypex coatings. Surfaces shall have a "tooth and suction" ICRI CSP-3 profile and be fully saturated with no glistening water on the surface.

STEP 6: Apply one coat of Xypex Concentrate at the rate of 1.25 - 1.5 lb./sq.yd. (0.65 - 0.8 kg/m²). After the Concentrate has set but while it is still "green", apply either a second coat of Xypex Concentrate or a coat of

Xypex Modified at the rate of 1.25 - 1.5 lb./sq.yd. (0.65 - 0.8 kg/m²).

STEP 7: Cure by keeping coating moist by misting or fog spraying periodically with water for 2 - 3 days. Place into service per Xypex coatings guidelines.

Note 1: A single heavy coat may be used in some situations. Contact Xypex Technical Services Representative for assistance.

Note 2: Details are shown for joints that incorporate a keyway. Non-keyway joint assemblies are illustrated in the Admix Schematic Drawings.

Note 3: Schematic diagram shows Xypex application details only and does not depict standard requirements for waterstops or expansion joints. Inclusion, type and position of waterstops are at the discretion of the designer. Expanding waterstops may be placed on the slurry coat after it has dried or before application. Slurry coat may only be applied over waterstop if approved by waterstop manufacturer.

Note 4: Schematic drawing shows Xypex coating application. Specifier may consider the alternative use of Xypex dry shake (DS-Series) or Xypex additive (Admix C-Series). Refer to Xypex Standard Specifications for more information.